

*** DANGER - CAUTION ***

Always Lower The Boat Lift Before Attempting Assembly.

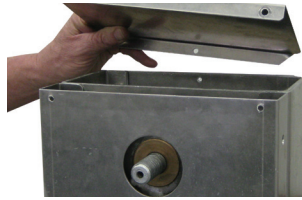

1. Lower the Boat Lift.
2. Remove the Wheel.
3. Remove the Top Cover.

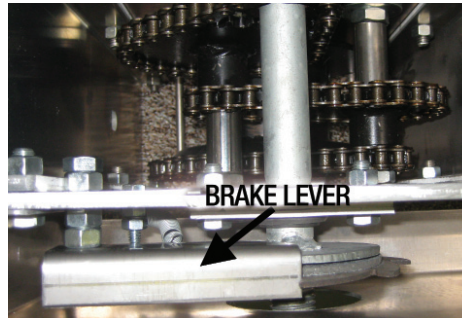

4. Remove the Brake Lever. You will not use the Brake Lever or Spring.

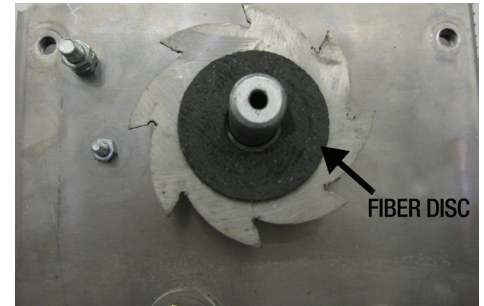

5. Remove the Brass Washer and Replace with the Fiber Disc.

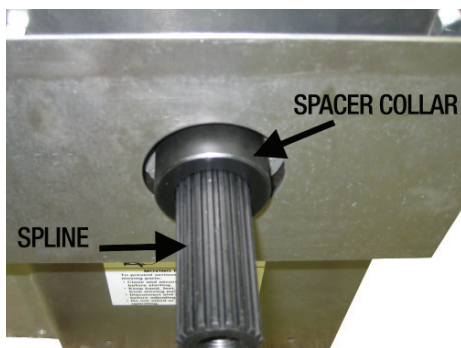

6. Install the Top Cover, Install the Spline, & Install the Spacer Collar.

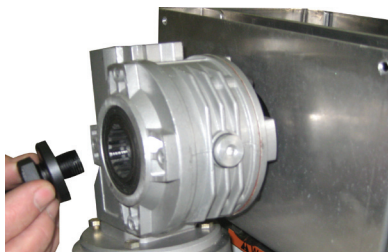

7. Slide the Motor down onto the Spline. Install the Bolt & Washer onto the Motor and Tighten to Approximately 70 Foot Pounds.

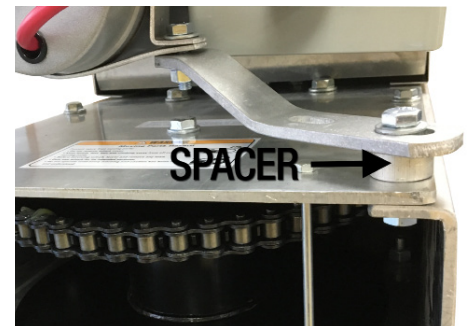

* Notice the Bolt Direction on the Strap. Longer Bolt and Spacer for Proper Alignment If Necessary. Make sure to use washers provided on smaller bolt if you use spacer.

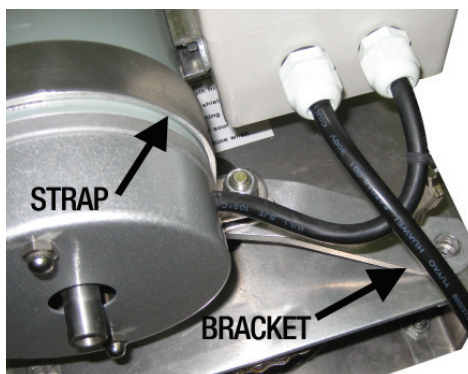

8. Install the Motor Strap around the Motor and Install the Bracket. Then Tighten both.

Recommended Extension Cords up to 150 feet 12/3.

Any Question Regarding Electrical Current Requirements Please Call Your Authorized Dealer or Lift Tech Marine 1-866-319-8877. WWW.LIFTTECHMARINE.COM

*** DANGER - CAUTION ***

All Power Used on Your Dock or Lift Needs to be GFI Protected at the Shoreline.

Most Common (MC) Installation Guide

MOTOR STRAP PINCHED TOGETHER



Install Bracket and Strap as shown above. You might not need the spacer depending on your brand of winch box.

Turn Page Over